

HERZ RL-1

Return valve without presetting

Data sheet for 3723 / 3724 / S 3724, Issue 0424

Special models R = R 1/2 G = G 3/4

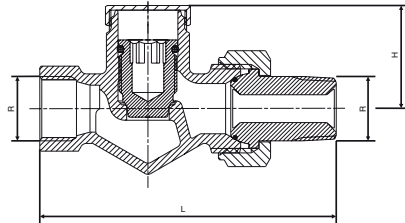

3723

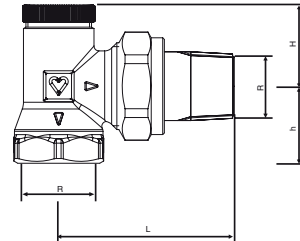

3724, S 3724

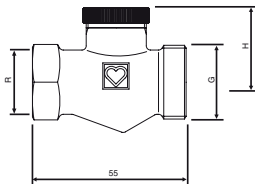

1 3723 11

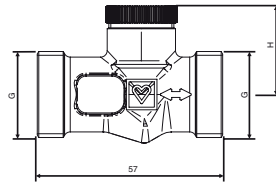

1 3737 01

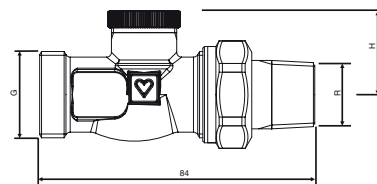

1 3733 11

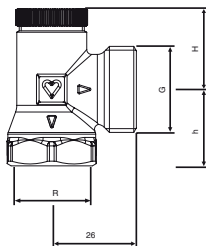

1 3724 71

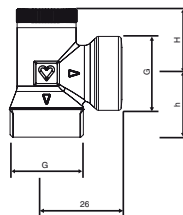

1 3724 37

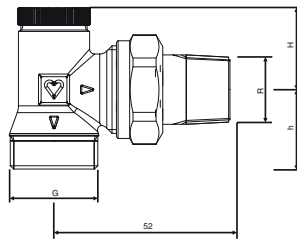

1 3748 01

Dimensions in mm
Order number

| Article Nr. | Model | R connection | Ø Connection | L | H | h | Order Nr. |
|-------------|----------------|--------------|--------------|----|----|----|-----------|
| 3723 | Straight model | 3/8 | 12 | 74 | 28 | - | 1 3723 40 |
| | | 1/2 | 15 | 82 | 28 | - | 1 3723 41 |
| | | 3/4 | 18 | 95 | 27 | - | 1 3723 42 |
| 3724 | Angle model | 3/8 | 12 | 47 | 20 | 2 | 1 3724 40 |
| | | 1/2 | 15 | 52 | 20 | 25 | 1 3724 41 |
| | | 1/2 | 15 | 52 | 20 | 25 | S 3724 01 |
| | | 3/4 | 18 | 60 | 21 | 27 | 1 3724 42 |

Models

All models are nickel-plated and are universal models with special socket for threaded pipe and compression adapter.

☑ HERZ-RL-1 Special models

HERZ-RL-1 Valves in special models, dimension 1/2

| | |
|-----------|---|
| 1 3737 01 | Straight model, 2 x male thread G 3/4, with cone seal |
| 1 3733 11 | Straight model, radiator connection with cone seal, pipe connection male thread G 3/4 |
| 1 3724 37 | Angle model, 2 x male thread G 3/4, with cone seal |
| 1 3748 01 | Angle model, radiator connection with cone seal, pipe connection male thread G 3/4 |

☑ Operating data

HERZ Compression adapter

| | |
|-------------------------------|--------|
| Maximum operating temperature | 110 °C |
| Maximum operating pressure | 10 bar |

Hot water purity according to Austrian standard ÖNORM H 5195 and/or VDI specification 2035.

When using HERZ compression adapters for copper and steel pipes, observe the permissible temperatures and pressures as specified in EN 1254-2:1998 Table 5. A maximum operating temperature of 80 °C and maximum operating pressure of 4 bar applies for plastic pipe connections, if permitted by the pipe manufacturer.

☑ Field of application

Hot Water Heating Systems.

After installation of the return valve it is possible to close the radiator return connection. When the intake valve is closed simultaneously (0-position for thermostatic valves) it is possible to remove the radiator while the heating system remains under pressure. Thus, it is possible to perform servicing operations and to work behind the radiator (wall-papering, laying tiles) without having to switch off the rest of the system.

If presetting of the return valve or filling and draining of the radiators or of the entire system through the return valve is required, we recommend using the HERZ-RL-5 return valve.

☑ Radiator connection

Iron pipe connection **6210**, with cone seal, assembled.
It is recommended that the HERZ assembly key **6680** be used.

☑ Further connection options

Please refer to the HERZ product range for order numbers.
Can be used instead of the radiator connection and on the external thread G 3/4.

| | |
|-----------------------|---|
| 6210 1/2 | Iron pipe connection, lengths 26 or 35 mm. |
| 6211 1/2 | Reducing connection, 1/2 x 3/8. |
| 6213 3/8 | Reducing connection, 3/8 x 1/2. |
| 6218 3/8 – 3/4 | Long threaded bush, without nut, can be shortened to compensate for differences in structural dimensions, lengths 3/8 x 40; 1/2 x 39, 42 and 76; 3/4 x 70 mm. |
| 6218 1/2 | Threaded bush, without nut, lengths 36, 48 and 76 mm. |
| 6235 3/8 – 3/4 | Soldering connection, 3/8 x 12; 1/2 x 12, 15 and 18; 3/4 x 18 mm. |
| 6249 3/8 – 3/4 | Iron pipe connection elbow, without nut, with cone seal |
| 6274 G 3/4 | Compression adapter for copper and thin-walled steel pipes, for external pipe diameters 8, 10, 12, 14, 15, 16 mm. |
| 6276 G 3/4 | Compression adapter with soft seal for copper and thin-walled steel pipes |
| 6098 G 3/4 | Compression adapter for PE-X-, PB and plastic composite pipes |

To be used at the socket side of the valve:

| | |
|------------------------|---|
| 6219 1/2 – 3/4 | Reduction socket, brass version, for pipe-valve connection, female thread (pipe) x male thread (valve), 1 x 1/2, 1 1/4 x 1/2, 1 x 3/4, 1 1/4 x 3/4. |
| 6066 M 22 x 1,5 | Plastic pipe connection for PE-X-, PB and plastic composite pipes, to be used with adapter 1 6272 01 (R 1/2 x M 22 x 1,5). |
| 6098 G 3/4 | Plastic pipe connection for PE-X-, PB and plastic composite pipes, to be used with adapter 1 6266 01 (R 1/2 x G 3/4). |

For pipe dimensions of plastic pipe connections please refer to HERZ product range.

Universal model

Pipe connection

The return valves are equipped with special sockets offering the option of connection either a threaded pipe or calibrated soft-steel or copper pipe, the latter two by means of a compression adapter.

Compression adapter must be ordered separately.

When using R=1/2" valves for external pipe diameter 10, 12, 14 and 16 mm use adapter Art. No.6272 between valve and compression adapter.

| | | | | | | | | |
|-------------------------|--|-----------|-----------|-----------|-----------|-----------|-----------|-----------|
| Pipe ø D mm | | 12 | 10 | 12 | 14 | 15 | 16 | 18 |
| Valve R= | | 3/8" | 1/2" | | | | | 3/4" |
| Adapter Art. No. | | | 1 6272 01 | 1 6272 01 | 1 6272 01 | | 1 6272 01 | |
| Compr. adapter Art. No. | | 1 6292 00 | 1 6292 00 | 1 6284 01 | 1 6284 03 | 1 6292 01 | 1 6284 05 | 1 6292 02 |

We suggest using support sleeves for the installation of soft-steel or copper pipes with screw joint.

For perfect installation, it is imperative to lubricate the thread of the locking nut (male thread and female thread) as well as the olive itself with silicon oil. We refer to our instructions for installation.

Special design features

Closing is performed by means of the valve spindle which can be turned to open or close by means of the HERZ Multi-purpose key 1 6625 00 or an 8 mm Allen key. The valve is completely open after 3 to 3 1/2 turns.

The seat seal is metallic and therefore non-wearing. The valve spindle is sealed towards outside by means of an O-Ring. This keeps maintenance requirements at a minimum and ensures ease of valve operation over a long period of time up to the specified operating temperature.

The spindle is protected against unintentional unscrewing. In addition, it is covered by a metallic screw cap.

kvs and Zeta value

| Characteristic | HERZ-RL-1 | k_{vs} | Zeta value for pipe according to DIN 2440 |
|----------------|--------------|----------|---|
| 1 | 3723 - 3/8 | 1,5 | 17 |
| 2 | 3723 - 1/2 | 1,9 | 29 |
| 3 | 3723 - 3/4 | 2,0 | 86 |
| 4 | 3724 - 3/8 | 2,15 | 8 |
| 5 | 3724 - 1/2 | 2,6 | 15 |
| | S 3724 - 1/2 | 2,6 | 15 |
| | 3724 - 3/4 | 2,6 | 51 |

Accessories

- 1 6625 00 Multi purpose key for pre-setting
- 1 6680 00 Assembly key for radiator connections

Disposal

Local and currently applicable legislation must be observed for disposal.

Material

Pursuant to Article 33 of the REACH Regulation (EC No. 1907/2006), we are obliged to point out that the material lead is listed on the SVHC list and that all brass components manufactured in our products exceed 0.1 % (w / w) lead (CAS: 7439-92-1 / EINECS: 231-100-4). Since lead is a component part of an alloy, actual exposure is not possible and therefore no additional information on safe use is necessary.

All specifications and statements within this document are according to information available at the time of printing and meant for informational purpose only. Herz Armaturen reserves the right to modify and change products as well as its technical specifications and/or it functioning according to technological progress and requirements. It is understood that all images of Herz products are symbolic representations and therefore may visually differ from the actual product. Colours may differ due to printing technology used. In case of any further questions don't hesitate to contact your closest HERZ Branch-office.

| | |
|-------------------------------|--|
| HERZ Standard diagram | HERZ-RL-1 |
| Art. No. 3723 · 3724 · S 3724 | Dim. DN 10 R = 3/8 · DN 15 R = 1/2 · DN 20 R = 3/4 |

