

## HERZ clever&smart LEDcontroller 3 F810 31

Digital room sensor for surface heating systems with built-in multi-sensor and digital communication via 1-wire bus in connection with the HERZ clever&smart Control Box. Intuitive operation via integrated touch areas and LEDs.

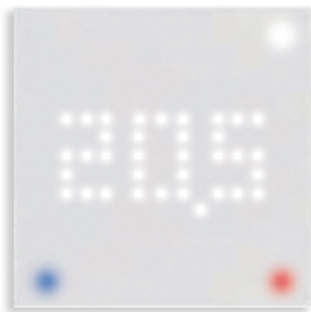

### Technical Data

<b>Power Supply</b>	5 VDC ( +/- 10 %)	<b>Protection Class</b>	IP 20
<b>power consumption</b>	0,6 W	<b>Dimension</b>	55 mm x 55 mm
<b>Measurement Range</b>		<b>Housing</b>	Plastic Pure white
Temperature:	0 °C ... 60 °C	<b>Mounting</b>	Surface / flush-mounted
- Accuracy / resolution:	+/- 1 °C / 0,1 °C		

## Wall mounting and electrical connection

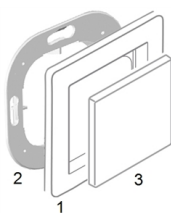

Mount the HERZ clever&smart LEDcontroller in a suitable place.



### Caution!

Device and function may be damaged. Select a suitable environmental condition. Direct sunlight, sources of heat and cold, e.g. radiators and windows must be avoided.

### Mounting in flush-mounted switch box

Attach the mounting ring (2) to the switch box. Make the electrical connection as described below.

### Electrical connection

Connect the sensor to the 1-Wire bus. GND = Grey, DQ= Orange, VCC= Red

### Attach insert

Hold the cover frame (1 - not included in the scope of delivery) against the mounting ring (2). Align the HERZ clever&smart LEDcontroller (3) with the mounting ring and press it in until it engages in the mounting ring.

### Surface mounting

Use the surface-mounted frame set 3 F810 52 for surface mounting.

## 1-Wire ID

1-Wire ID:  
E0-D5-5E-0E-69-F1

Each HERZ clever&smart LEDcontroller has a unique 1-Wire ID. This ID is required for sensor room assignment in the HERZ clever&smart Control Box. You will find the ID on the small sticker supplied.

## LED

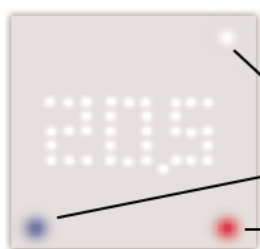

LED white = Touch registered - operation active

LED blue = Reduce setpoint

LED red = Raise setpoint

## Operation

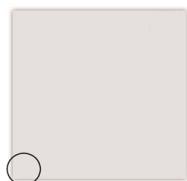

### Standby Screen

Touching the touch areas activates the device.

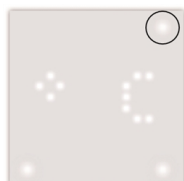

### Measuring unit and measured value display

The first touch of the touch area shows the temperature. Repeated touching changes to other measured values and first shows the unit and after a short time the measured value.

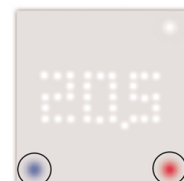

### Setpoint adjustment

The set temperature can be reduced or increased by touching the blue and red touch areas.

## HERZ clever&smart LEDcontroller room assignment

There are two ways to assign a room to the HERZ clever&smart LEDcontroller:

- Using the unit ID via the HERZ clever&smart Room Controller menu 'Expert -> Settings -> Rooms -> Room X -> Temperature'.
- As described under 1. via the HERZ clever&smart Room Controller menu in combination with the Touch-To-Assign function (T2A) on the HERZ clever&smart LEDcontroller.

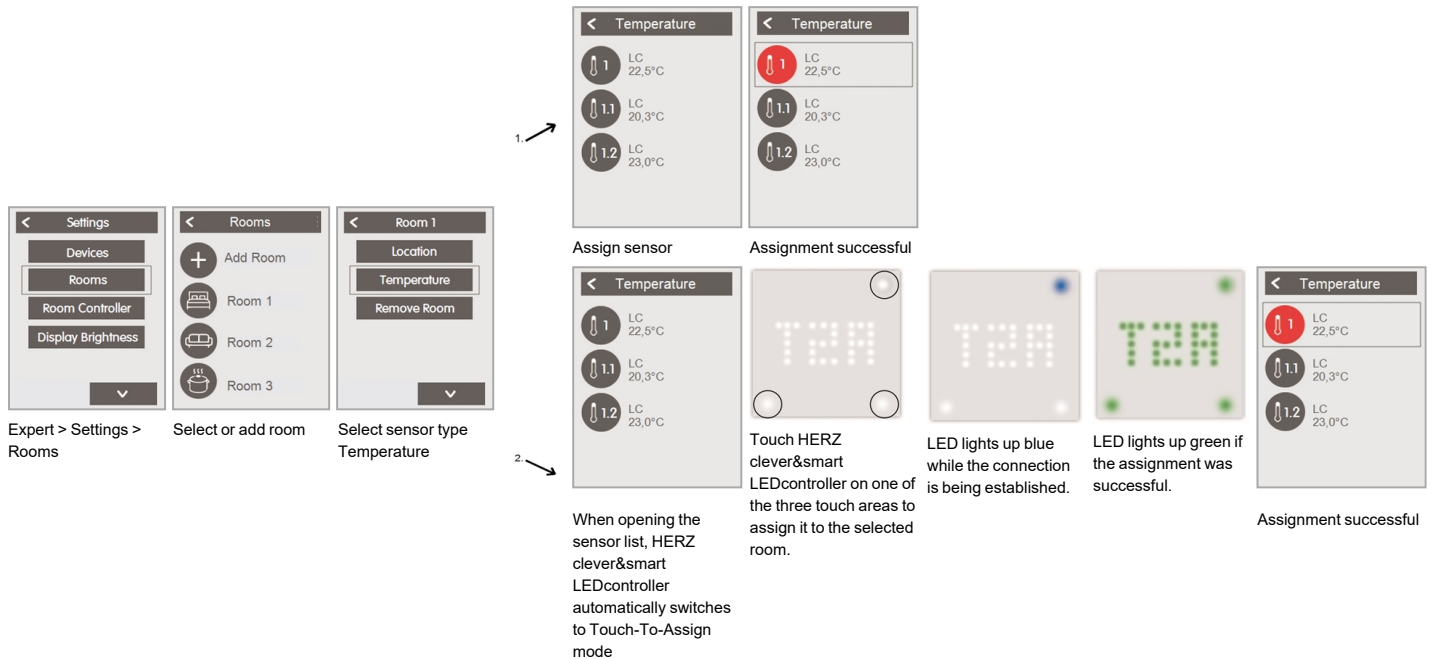

## Set room setpoint

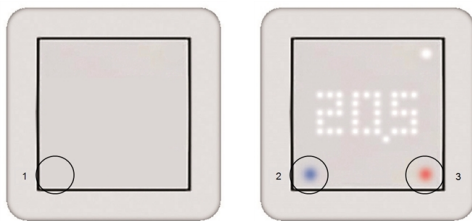

- Activate the room setpoint menu (1) by touching the touch area (1).
- Reduce (2) or increase (3) the room setpoint by touching the touch areas.

After 20 seconds, the display returns to the standby screen. The set room setpoint is valid until the next change via HERZ clever&smart Room Controller timer or manually.

## HERZ clever&smart LEDcontroller with HERZ clever&smart Control Box

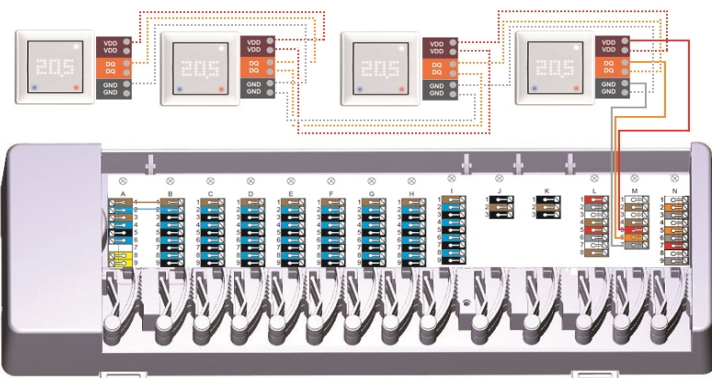

The 1-Wire system must be designed with 3 wires (5 VDC, DQ, GND). The wiring must be done in series, see diagram opposite. Stub lines should be avoided or made as short as possible. The total cable length can be up to 100 m. Use a suitable twisted pair cable and ensure sufficient conductor cross-section, e.g. LIYCY 2 x 2 x 0.75 mm<sup>2</sup>, in order to avoid impermissible voltage drop at the HERZ clever&smart LEDcontroller below  $U_{min} = 4.5$  VDC.