

HERZ STRÖMAX GNW

Regulating valve with measuring valves for drinking water



- ❑ Balancing valve with equal percentage characteristic
- ❑ ÜA installation sign for legally compliant installation in drinking water installations
- ❑ Dezincification-resistant brass suitable for drinking water according to the current UBA list and the 4MS list
- ❑ Measuring valves along one axis for best accessibility
- ❑ Stepless adjustment including stroke limiter
- ❑ Clearly legible display of the setting on the handwheel shaft
- ❑ Spindle seal with two O-rings

HERZ STRÖMAX GNW

STRÖMAX-GNW double regulating and commissioning valve with measuring valves, DN 15 - 50, with equal percentage characteristic. Straight pattern, socket x socket, rising spindle, spindle seal with double O-ring, presetting by stroke limitation, presetting level display on the handwheel shaft. 2 measuring valves are mounted next to the hand wheel.

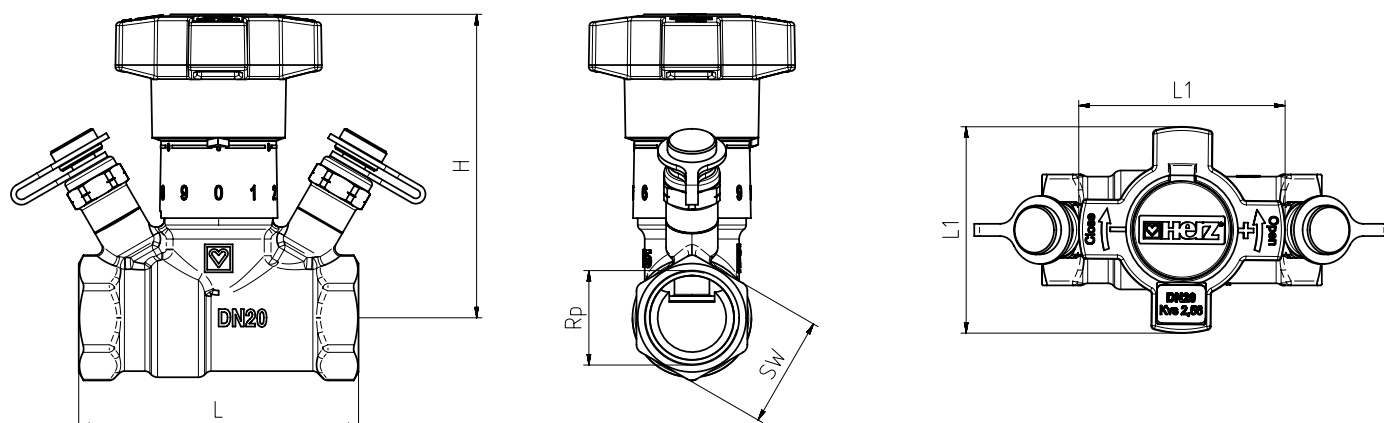

Order number	DN	Rp	L	L1	H (close/open)	SW 6-point	SW 8-point	Weight, kg	kvs
2 4217 71	15	½"	78	59	84/92	27		0,50	1,76
2 4217 72	20	¾"	80	59	84/95	32		0,58	2,38
2 4217 73	25	1"	88	59	94/102	41		0,81	5,24
2 4217 74	32	1 ¼"	106	59	102/114		50	1,20	8,56
2 4217 75	40	1 ½"	116	59	102/114		55	1,37	11,53
2 4217 76	50	2"	132	59	107/119		70	2,06	17,16



☑ Technical data

Max. operating temperature: 85 °C
Max. working pressure: 25 bar

☑ Measuring valves

The two measuring valves are mounted next to the handwheel.
This arrangement ensures the best accessibility and optimal connection of measuring devices in all installation positions.

☑ Field of application

The line regulating valve 4217 GNW is used to regulate and shut off drinking water systems in buildings and for hydraulic balancing of supply lines.

☑ Flow direction

During installation, the direction of flow must be observed according to the arrow on the housing.

☑ Installation position

Installation is possible in any position. The arrangement of the hand wheel and measuring valves on one level always enables the best possible accessibility and operability of the valve.

Herz Armaturen Ges.m.b.H.

Richard-Strauss-Straße 22, 1230 Vienna, Austria
T: +43 1 616 26 31-0, F: +43 1 616 26 31-227
E-Mail: office@herz.eu

www.herz.eu

