

# HERZ STRÖMAX GN

Balancing valve with measuring valves

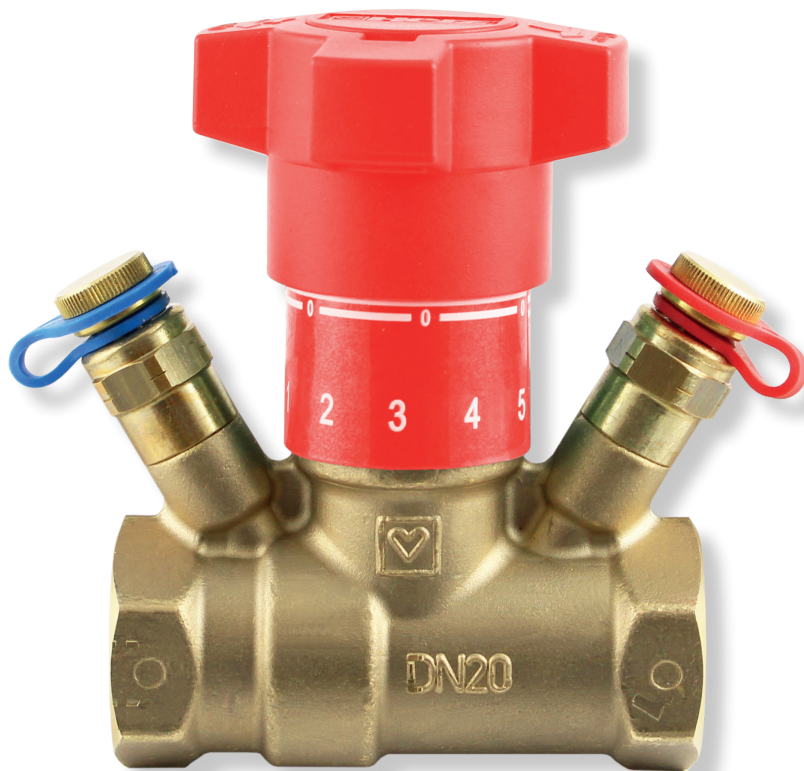

- ☑ Balancing valve with equal percentage characteristic
- ☑ Measuring valves along one axis for best accessibility
- ☑ Stepless adjustment including stroke limiter
- ☑ Hidden backup of the setting
- ☑ Clearly legible display of the setting on the handwheel shaft
- ☑ Dezincification resistant brass for long life
- ☑ Spindle seal with two O-rings
- ☑ Compact dimensions

# HERZ STRÖMAX GN

STRÖMAX-GN double regulating and commissioning valve with measuring valves, DN 15 - 50, with equal percentage characteristic. Straight pattern, socket x socket, rising spindle, spindle seal with double O-ring, presetting by stroke limitation, presetting level display on the handwheel shaft. 2 measuring valves are mounted next to the hand wheel.

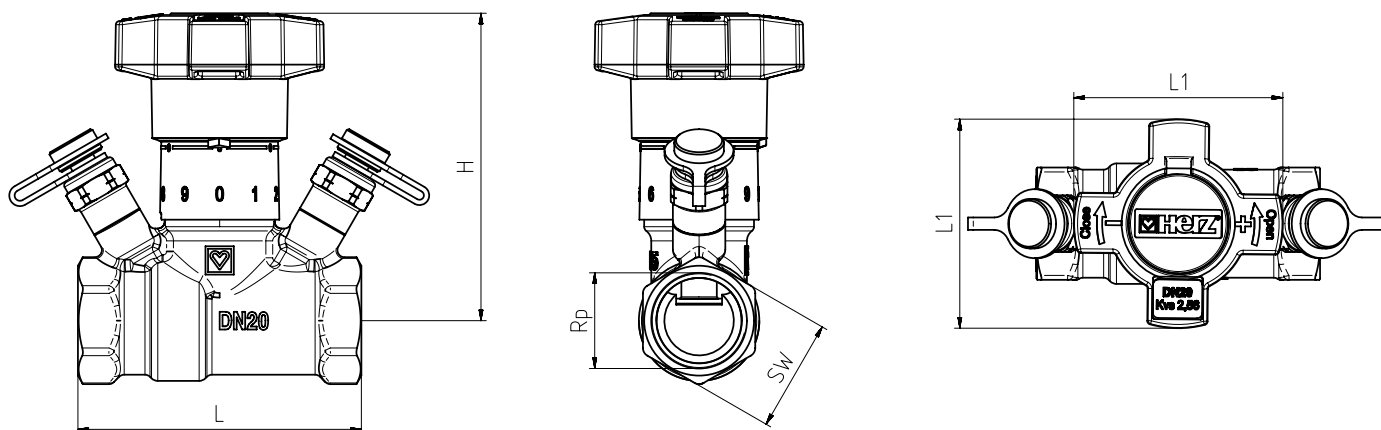

Order number	DN	Rp	L	L1	H (close/open)	SW 6-point	SW 8-point	Weight, kg	kvs
1 4217 71	15	½"	78	59	84/92	27		0,50	1,76
1 4217 72	20	¾"	80	59	84/95	32		0,58	2,38
1 4217 73	25	1"	88	59	94/102	41		0,81	5,24
1 4217 74	32	1 ¼"	106	59	102/114		50	1,20	8,56
1 4217 75	40	1 ½"	116	59	102/114		55	1,37	11,53
1 4217 76	50	2"	132	59	107/119		70	2,06	17,16

## ☑ Technical data

Max. operating temperature: 130 °C (up to DN 32)  
 Max. operating temperature: 110 °C (up to DN 40)  
 Min. operating temperature: 2 °C (Water), - 20 °C (Antifreeze)  
 Max. working pressure: 25 bar

## ☑ Measuring valves

The two measuring valves are mounted next to the handwheel. This arrangement ensures the best in all installation positions. Accessibility and optimal connection of measuring devices.

## ☑ Field of application

The balancing valve 4217 GN is used for hydraulic balancing in heating and cooling systems and for adjustment of distribution lines, lines, heat exchangers as well as heating and cooling registers.

## ☑ Flow direction

During installation, the direction of flow must be observed according to the arrow on the housing.

## ☑ Installation position

Installation is possible in any position. The arrangement of the handwheel and measuring valves in one plane allows optimal assembly conditions and operability of the valve at all times.

## Herz Armaturen Ges.m.b.H.

Richard-Strauss-Straße 22, 1230 Vienna, Austria  
 T: +43 1 616 26 31-0, F: +43 1 616 26 31-227  
 E-Mail: office@herz.eu

[www.herz.eu](http://www.herz.eu)

